

CONSTRUCTION REQUIREMENTS FOR A FOOD BOOTH HAND WASH SINK

BASED ON REQUIREMENTS OF THE CALIFORNIA RETAIL FOOD CODE (CalCode) AND GUIDANCE FROM FRESNO COUNTY PUBLIC WORKS

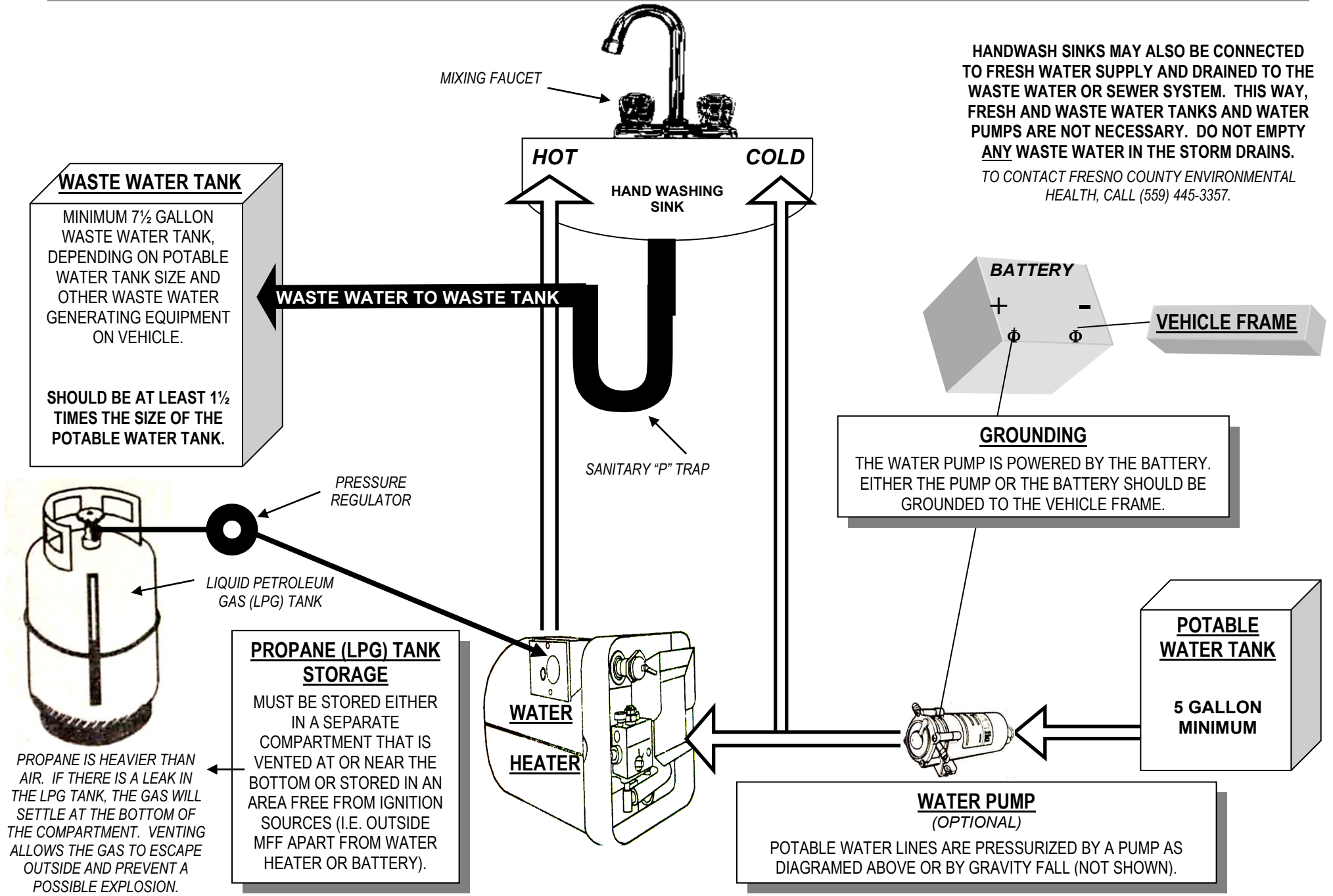

WASTE WATER TANK

MINIMUM 7½ GALLON WASTE WATER TANK, DEPENDING ON POTABLE WATER TANK SIZE AND OTHER WASTE WATER GENERATING EQUIPMENT ON VEHICLE.

SHOULD BE AT LEAST 1½ TIMES THE SIZE OF THE POTABLE WATER TANK.

WASTE WATER TO WASTE TANK

MIXING FAUCET

HOT

COLD

HAND WASHING SINK

SANITARY "P" TRAP

PRESSURE REGULATOR

LIQUID PETROLEUM GAS (LPG) TANK

PROPANE (LPG) TANK STORAGE

MUST BE STORED EITHER IN A SEPARATE COMPARTMENT THAT IS VENTED AT OR NEAR THE BOTTOM OR STORED IN AN AREA FREE FROM IGNITION SOURCES (I.E. OUTSIDE MFF APART FROM WATER HEATER OR BATTERY).

PROPANE IS HEAVIER THAN AIR. IF THERE IS A LEAK IN THE LPG TANK, THE GAS WILL SETTLE AT THE BOTTOM OF THE COMPARTMENT. VENTING ALLOWS THE GAS TO ESCAPE OUTSIDE AND PREVENT A POSSIBLE EXPLOSION.

WATER

HEATER

HANDWASH SINKS MAY ALSO BE CONNECTED TO FRESH WATER SUPPLY AND DRAINED TO THE WASTE WATER OR SEWER SYSTEM. THIS WAY, FRESH AND WASTE WATER TANKS AND WATER PUMPS ARE NOT NECESSARY. DO NOT EMPTY ANY WASTE WATER IN THE STORM DRAINS.

TO CONTACT FRESNO COUNTY ENVIRONMENTAL HEALTH, CALL (559) 445-3357.

BATTERY

VEHICLE FRAME

GROUNDING

THE WATER PUMP IS POWERED BY THE BATTERY. EITHER THE PUMP OR THE BATTERY SHOULD BE GROUNDED TO THE VEHICLE FRAME.

POTABLE WATER TANK

5 GALLON MINIMUM

WATER PUMP (OPTIONAL)

POTABLE WATER LINES ARE PRESSURIZED BY A PUMP AS DIAGRAMED ABOVE OR BY GRAVITY FALL (NOT SHOWN).